



Part No.  
**039**



# Assembly Instructions

## **SENTINEL**

Wind driven bird scarer

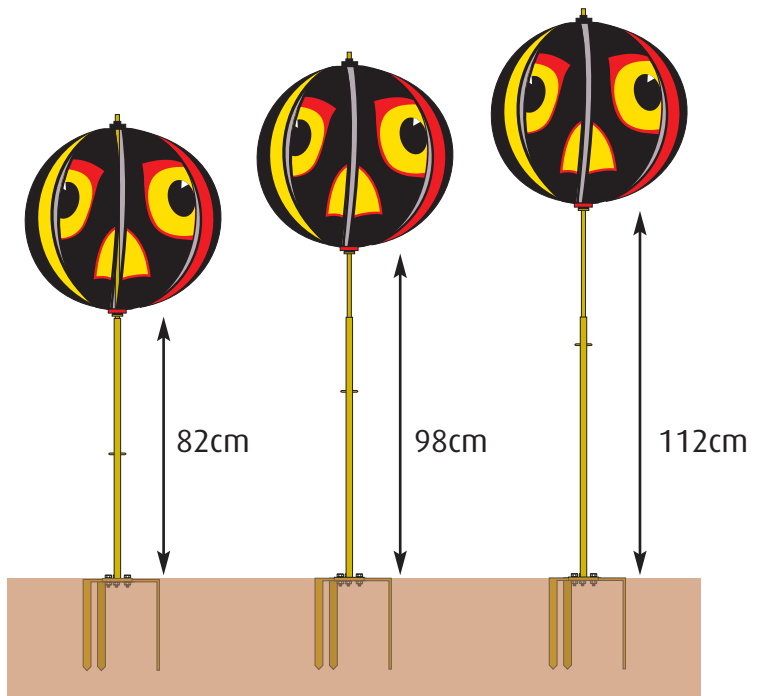

### **Portek Limited**

Bryn Hall, Knolton Bryn, Overton-on-Dee, Wrexham, LL13 0LF.  
Tel: +44(0)1234 88 94 54 Fax: +44(0)1234 88 94 64



**www.portek.co.uk**

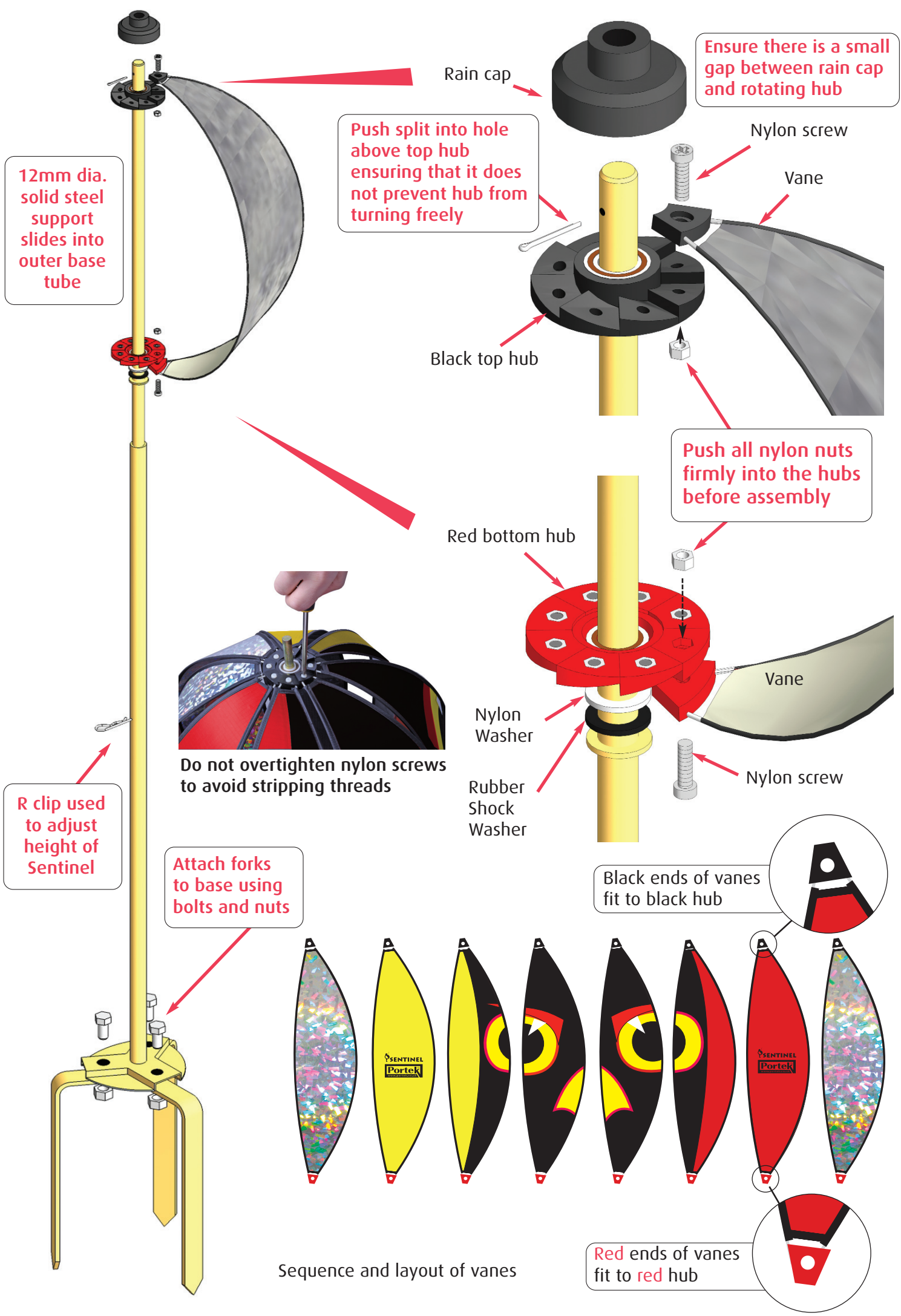

Ensure there is a small gap between rain cap and rotating hub

Rain cap

Push split into hole above top hub ensuring that it does not prevent hub from turning freely

Nylon screw

Vane

12mm dia. solid steel support slides into outer base tube

Black top hub

Push all nylon nuts firmly into the hubs before assembly

Red bottom hub

Vane

Do not overtighten nylon screws to avoid stripping threads

Nylon Washer

Rubber Shock Washer

Nylon screw

R clip used to adjust height of Sentinel

Attach forks to base using bolts and nuts

Black ends of vanes fit to black hub



Sequence and layout of vanes

Red ends of vanes fit to red hub